

Supplement to Graymills manual 795-09456

**⚠ CAUTION** See manual 795-09456 for all Cautions & Warnings before installing fuse

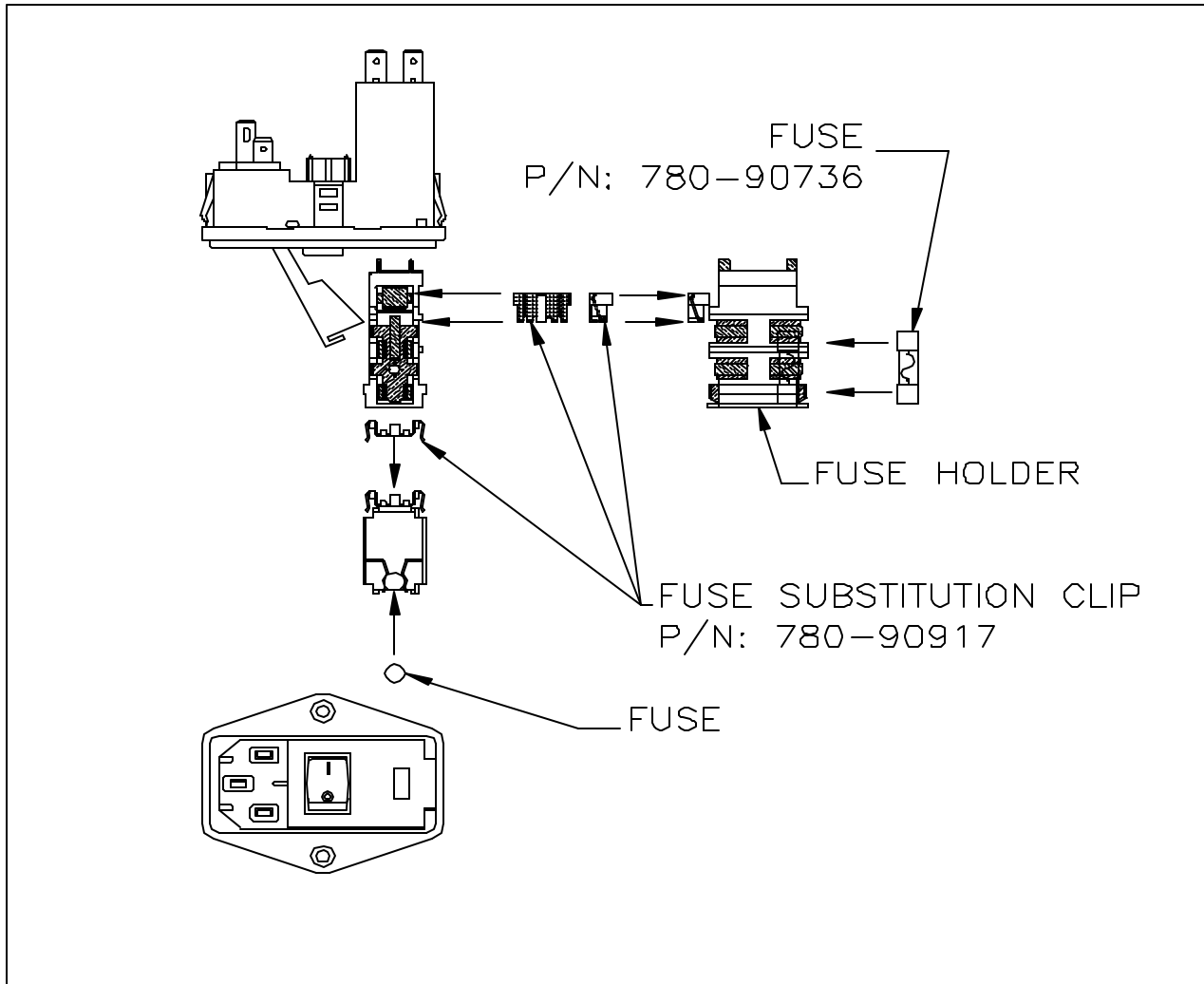

### Replacing the Fuse(s) – All models

To change the fuse on the 115VAC models:

- 1) Unplug the power cord from the power receptacle.
- 2) Open the Fuse holder door and remove the fuse holder.
- 3) Remove and replace the blown fuse with the new fuse. Make sure that the Fuse Substitution Clip is in the location indicated in the above diagram.
- 4) Install the Fuse holder in the Power Entry Module. (Make sure that the Fuse Substitution Clip is facing UP) and close the door.
- 5) Re-install the power cord.

The fuse substitution clip is only to be used for 115VAC pump operation.

To change the fuse on 230VAC models:

- 1) Unplug the power cord from the power receptacle.
- 2) Open the Fuse holder door and remove the fuse holder.
- 3) Remove and replace the blown fuse(s) with the new fuse(s).
- 4) Install the Fuse holder in the Power Entry Module and close the door.
- 5) Re-install the power cord

For 115VAC pump operation use one (1)) fuse.

For 230VAC pump operation use two (2) fuses.

Graymills part number: # 780-90736 (ø5mm x 20mm, 2.5 Amp, 250 VAC, fast acting fuse)

### **FUSING FOR THE PPS-DV-CE MODEL**

To operate the pump on 115VAC:

- 1) Open the Fuse holder door and remove the fuse holder.
- 2) Remove and replace one fuse with the Fuse Substitution Clip in the location indicated in the attached diagram.
- 3) Install the Fuse holder in the Power Entry Module. (Make sure that the Fuse Substitution Clip is facing UP) and close the door.
- 4) Move the Voltage Selection Switch to indicate 115V.
- 5) Install a plug suitable for a 115V, receptacle, to the supply end of the power cord.

The fuse substitution clip is only to be used for 115VAC pump operation.

For 115VAC pump operation use one (1)) fuse, Graymills part number: # 780-90736 (ø5mm x 20mm, 2.5 Amp, 250 VAC, fast acting fuse)

To operate the pump on 230VAC:

- 1) Open the Fuse holder door and remove the fuse holder.
- 2) Remove and replace the Fuse Substitution Clip (if fitted with one) with a Fuse (Graymills P/N: # 780-90736)
- 3) Install the Fuse holder in the Power Entry Module. (Make sure that the Fuse holder contains both fuses) and close the door.
- 4) Move the Voltage Selection Switch to indicate 230V
- 5) Install a plug suitable for a 230V, receptacle, to the supply end of the power cord

For 230VAC pump operation use two (2) fuses, Graymills part number: # 780-90736 (ø5mm x 20mm, 2.5 Amp, 250 VAC, fast acting fuse)

**Graymills 3705 N. Lincoln Avenue Chicago, IL 60613**

[www.graymills.com](http://www.graymills.com)

773-248-6825

Fax 773-477-8673